

1. Dimensions

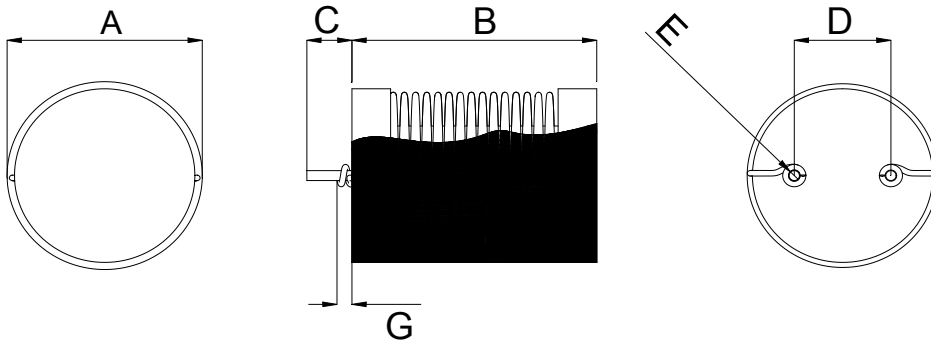

Dimensions do not include the solder on the terminal pins.

A	B	C	D	E	G
17.0 max.	21.0 max.	5.0 ± 0.5	7.5 ± 0.5	0.8 ref.	1.3 ± 0.3

Unit: mm

2. Schematics

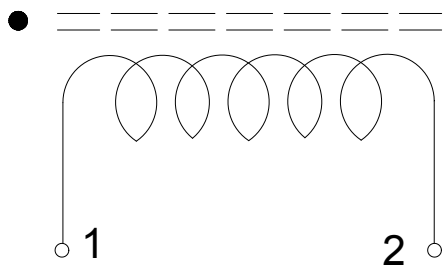

RoHS
Compliant

3. Electrical Characteristics

Part Number	Inductance (μH) ①	Inductance tolerance	DCR (mΩ) ②	Isat max. (A) ③	Irms typ. (A) ④
TDR1419S-501MB01	500	±20%	350 ± 25%	2.5	1.4
TDR1419S-102MB01	1000	±20%	480 ± 30%	1.5	1.3

- ① Inductance tested at 1kHz/0.3V, using an Agilent/HP 4192A or equivalent. 电感测试: HP4192A, 1kHz/0.3V.
- ② DCR measured on a micro-ohmmeter./DCR测试用微欧计。
- ③ Isat : The DC current at which the inductance decreases by 20% from it's initial value/. 电感下降20%对应的DC电流值。.
- ④ I rms: The DC current at which Δt=40°C/ 温升40°C对应的电流值 (Ta=20°C).

These are only typical designs for your reference, custom design is available for your exact requirements.