

1. Dimensions

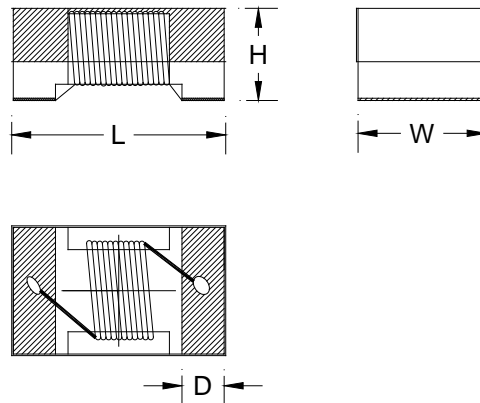

L	W	H	D
3.50 max.	2.90 max.	2.25 max.	0.50 typ.

2. Recommended Land Pattern

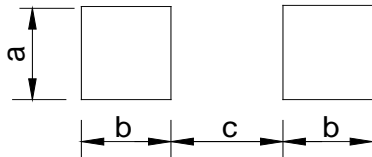

Symbol	Dimensions(mm)
a	2.54
b	1.02
c	1.78

2. Product Identification

KTW 1210 IF 1N0 □ S C
 ① ② ③ ④ ⑤ ⑥ ⑦

- ① Wire Wound Inductor Series;
- ② Dimensions: 1210(inch)= 3225(mm)=3.2×2.5mm
- ③ Material: IF Ferrite core;
- ④ Inductance: 1N0=1.0nH、010=10nH、R10=100nH、1R0=1.0μH、100=10μH、101=100μH、102=1mH;
- ⑤ Tolerance: G---±2%; J---±5%; K---±10%;
- ⑥ Terminal: G--- Gold; S--- Tin;
- ⑦ Packaging type: C--- Tape& Reel.

3. Electrical Characteristics

Part Number	Accuracy grade	Inductance ^① (uH)	Inductance Test Conditions	Q value min.	Q value Test frequency (MHz)	DCR ^② (Ω)max.	Rated current ^③ (mA)	SRF(MHz) min.
KTW1210IFR12□GC	J、K	0.12	25.2MHz/0.5V	20	25.2	0.20	450	850
KTW1210IFR27□GC	J、K	0.27	25.2MHz/0.5V	20	25.2	0.20	450	700
KTW1210IFR33□GC	J、K	0.33	25.2MHz/0.5V	20	25.2	0.30	450	520
KTW1210IFR47□GC	J、K	0.47	25.2MHz/0.5V	20	25.2	0.30	450	480
KTW1210IFR82□GC	J、K	0.82	25.2MHz/0.5V	20	25.2	0.30	450	350
KTW1210IF1R0□GC	J、K	1.0	7.96MHz/0.5V	12	7.96	0.30	450	220
KTW1210IF1R2□GC	J、K	1.2	7.96MHz/0.5V	12	7.96	0.30	450	210
KTW1210IF1R5□GC	J、K	1.5	7.96MHz/0.5V	12	7.96	0.40	450	200
KTW1210IF1R8□GC	J、K	1.8	7.96MHz/0.5V	12	7.96	0.50	450	195
KTW1210IF2R2□GC	J、K	2.2	7.96MHz/0.5V	12	7.96	0.60	450	175
KTW1210IF2R7□GC	J、K	2.7	7.96MHz/0.5V	12	7.96	0.70	420	120
KTW1210IF3R3□GC	J、K	3.3	7.96MHz/0.5V	12	7.96	1.10	380	80
KTW1210IF3R9□GC	J、K	3.9	7.96MHz/0.5V	12	7.96	1.20	360	75
KTW1210IF4R3□GC	J、K	4.3	7.96MHz/0.5V	12	7.96	1.20	360	70
KTW1210IF4R7□GC	J、K	4.7	7.96MHz/0.5V	12	7.96	1.30	350	60
KTW1210IF5R6□GC	J、K	5.6	7.96MHz/0.5V	12	7.96	2.00	320	50
KTW1210IF6R8□GC	J、K	6.8	7.96MHz/0.5V	12	7.96	1.50	310	35
KTW1210IF8R2□GC	J、K	8.2	7.96MHz/0.5V	12	7.96	1.60	305	35
KTW1210IF100□GC	J、K	10	2.52MHz/0.5V	10	2.52	1.00	300	30
KTW1210IF120□GC	J、K	12	2.52MHz/0.5V	10	2.52	1.20	265	25
KTW1210IF130□GC	J、K	13	2.52MHz/0.5V	10	2.52	1.20	250	22
KTW1210IF150□GC	J、K	15	2.52MHz/0.5V	10	2.52	2.00	225	22
KTW1210IF180□GC	J、K	18	2.52MHz/0.5V	10	2.52	2.10	210	22
KTW1210IF200□GC	J、K	20	2.52MHz/0.5V	10	2.52	2.40	200	20
KTW1210IF220□GC	J、K	22	2.52MHz/0.5V	10	2.52	2.40	200	20
KTW1210IF270□GC	J、K	27	2.52MHz/0.5V	10	2.52	2.70	180	18
KTW1210IF330□GC	J、K	33	2.52MHz/0.5V	10	2.52	2.90	160	15
KTW1210IF350□GC	J、K	35	2.52MHz/0.5V	10	2.52	4.20	145	16
KTW1210IF390□GC	J、K	39	2.52MHz/0.5V	10	2.52	4.70	150	16

All specifications are subject to change without notice.

KTW1210IF Series

Wire Wound Chip Inductors

Part Number	Accuracy grade	Inductance ^① (uH)	Inductance Test Conditions	Q value min.	Q value Test frequency (MHz)	DCR ^② (Ω)max.	Rated current ^③ (mA)	SRF(MHz) min.
KTW1210IF470□GC	J、K	47	2.52MHz/0.5V	10	2.52	5.20	140	10
KTW1210IF560□GC	J、K	56	2.52MHz/0.5V	10	2.52	5.60	125	8.0
KTW1210IF680□GC	J、K	68	2.52MHz/0.5V	10	2.52	4.70	110	5.0
KTW1210IF750□GC	J、K	75	2.52MHz/0.5V	10	2.52	5.50	100	5.0
KTW1210IF820□GC	J、K	82	2.52MHz/0.5V	10	2.52	5.60	100	5.0
KTW1210IF880□GC	J、K	88	2.52MHz/0.5V	10	2.52	6.00	95	5.0
KTW1210IF101□GC	J、K	100	0.796MHz/0.5V	8	0.796	6.80	95	5.0
KTW1210IF121□GC	J、K	120	0.796MHz/0.5V	8	0.796	7.90	85	4.0
KTW1210IF151□GC	J、K	150	0.796MHz/0.5V	8	0.796	9.00	80	4.0
KTW1210IF161□GC	J、K	160	0.796MHz/0.5V	8	0.796	9.10	75	3.0
KTW1210IF181□GC	J、K	180	0.796MHz/0.5V	8	0.796	14.5	70	3.0
KTW1210IF201□GC	J、K	200	0.796MHz/0.5V	8	0.796	16.5	65	2.5
KTW1210IF221□GC	J、K	220	0.796MHz/0.5V	8	0.796	16.5	65	2.6
KTW1210IF271□GC	K	270	0.796MHz/0.5V	8	0.796	18.0	60	2.5
KTW1210IF301□GC	K	300	0.796MHz/0.5V	8	0.796	20.0	55	2.4
KTW1210IF331□GC	K	330	0.796MHz/0.5V	8	0.796	19.0	55	2.3
KTW1210IF391□GC	K	390	0.796MHz/0.5V	8	0.796	21.5	45	2.2
KTW1210IF471□GC	K	470	0.796MHz/0.5V	8	0.796	22.5	40	2.0
KTW1210IF561□GC	K	560	0.796MHz/0.5V	8	0.796	28.0	30	1.5

- ① Inductance tested using an Agilent/HP4286A or equivalent.
- ② DCR measured on a micro-ohmmeter.
- ③ Rated current: The DC current at which the temperature rise $\Delta t=40^{\circ}\text{C}$ ($T_a=20^{\circ}\text{C}$).
- ④ □ Represents the tolerance of inductance: G ($\pm 2\%$); J ($\pm 5\%$); K ($\pm 10\%$).

4. Packaging Quantity: 2000 pcs per Reel.