

1. Dimensions

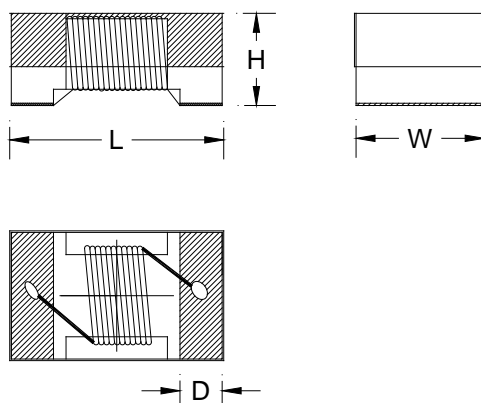

L	W	H	D
3.50 max.	2.90 max.	2.25 max.	0.50 typ.

2. Recommended Land Pattern

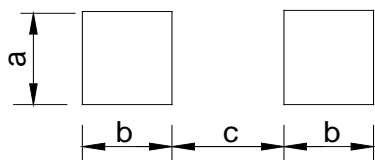

Symbol	Dimensions(mm)
a	2.54
b	1.02
c	1.78

2. Product Identification

KTW 1210 HC 1N0 □ S C
 ① ② ③ ④ ⑤ ⑥ ⑦

- ① Wire Wound Inductor Series;
- ② Dimensions: 1210(inch)=3225(mm)=3.2x2.5mm
- ③ Material: HC Ceramic core;
- ④ Inductance: 1N0=1.0nH、010=10nH、R10=100nH、1R0=1.0μH、100=10μH、101=100μH、102=1mH;
- ⑤ Tolerance: G---±2%; J---±5%; K---±10%;
- ⑥ Terminal: G--- Gold; S--- Tin;
- ⑦ Packaging type: C--- Tape& Reel.

3. Electrical Characteristics

Part Number	Accuracy grade	Inductance ① (nH)	Inductance Test Conditions	Q value min.	Q value Test frequency (MHz)	DCR ② (Ω)max.	Rated current ③ (mA)	SRF(MHz) min.
KTW1210HC3N9□GC	K	3.9	100MHz/0.5V	30	300	0.05	1000	6000
KTW1210HC4N7□GC	J、K	4.7	100MHz/0.5V	30	300	0.065	1000	5800
KTW1210HC8N2□GC	K	8.2	100MHz/0.5V	30	300	0.07	1000	5500
KTW1210HC010□GC	G、J、K	10	100MHz/0.5V	40	300	0.08	1000	4000
KTW1210HC012□GC	G、J、K	12	100MHz/0.5V	40	300	0.08	1000	3200
KTW1210HC015□GC	J、K	15	100MHz/0.5V	40	300	0.10	1000	3200
KTW1210HC018□GC	G、J、K	18	100MHz/0.5V	50	300	0.10	1000	2800
KTW1210HC022□GC	G、J、K	22	100MHz/0.5V	50	300	0.10	1000	2000
KTW1210HC027□GC	G、J、K	27	100MHz/0.5V	50	300	0.11	1000	1800
KTW1210HC033□GC	G、J、K	33	100MHz/0.5V	55	300	0.11	1000	1800
KTW1210HC039□GC	G、J、K	39	100MHz/0.5V	55	300	0.12	1000	1800
KTW1210HC043□GC	G、J、K	43	100MHz/0.5V	55	300	0.12	1000	1500
KTW1210HC047□GC	G、J、K	47	100MHz/0.5V	55	300	0.13	1000	1500
KTW1210HC056□GC	G、J、K	56	100MHz/0.5V	55	300	0.14	1000	1450
KTW1210HC068□GC	G、J、K	68	100MHz/0.5V	55	300	0.15	900	1200
KTW1210HC082□GC	G、J、K	82	100MHz/0.5V	55	300	0.20	900	1000
KTW1210HCR10□GC	G、J、K	100	100MHz/0.5V	55	300	0.21	850	900
KTW1210HCR12□GC	G、J、K	120	100MHz/0.5V	60	300	0.21	800	800
KTW1210HCR15□GC	G、J、K	150	100MHz/0.5V	60	300	0.25	750	780
KTW1210HCR18□GC	G、J、K	180	50MHz/0.5V	60	300	0.30	700	760
KTW1210HCR20□GC	G、J、K	200	50MHz/0.5V	60	300	0.31	680	650
KTW1210HCR22□GC	G、J、K	220	50MHz/0.5V	60	300	0.32	670	650
KTW1210HCR24□GC	G、J、K	240	50MHz/0.5V	60	300	0.32	650	600
KTW1210HCR27□GC	G、J、K	270	50MHz/0.5V	55	300	0.34	630	620
KTW1210HCR30□GC	G、J、K	300	50MHz/0.5V	45	150	0.35	600	600
KTW1210HCR33□GC	G、J、K	330	50MHz/0.5V	45	150	0.38	590	600
KTW1210HCR37□GC	G、J、K	370	50MHz/0.5V	45	150	0.50	550	550
KTW1210HCR39□GC	G、J、K	390	50MHz/0.5V	45	150	0.58	530	510
KTW1210HCR43□GC	G、J、K	430	50MHz/0.5V	45	150	0.65	500	500
KTW1210HCR47□GC	G、J、K	470	50MHz/0.5V	45	150	0.80	490	500
KTW1210HCR56□GC	G、J、K	560	35MHz/0.5V	45	150	1.10	460	420
KTW1210HCR60□GC	G、J、K	600	35MHz/0.5V	45	150	1.20	450	420

All specifications are subject to change without notice.

KTW1210HC Series

Wire Wound Chip Inductors

Part Number	Accuracy grade	Inductance ① (nH)	Inductance Test Conditions	Q value min.	Q value Test frequency (MHz)	DCR ② (Ω)max.	Rated current ③ (mA)	SRF(MHz) min.
KTW1210HCR62□GC	G、J、K	620	35MHz/0.5V	45	150	1.20	430	420
KTW1210HCR68□GC	G、J、K	680	35MHz/0.5V	45	150	1.20	430	400
KTW1210HCR75□GC	G、J、K	750	35MHz/0.5V	45	150	1.70	400	380
KTW1210HCR82□GC	G、J、K	820	35MHz/0.5V	45	150	1.82	400	370
KTW1210HCR88□GC	G、J、K	880	35MHz/0.5V	45	150	1.85	350	360
KTW1210HCR91□GC	G、J、K	910	35MHz/0.5V	45	150	1.85	350	360
KTW1210HC1R0□GC	G、J、K	1000	35MHz/0.5V	45	150	1.85	320	340
KTW1210HC1R2□GC	G、J、K	1200	35MHz/0.5V	35	150	1.87	300	220
KTW1210HC1R3□GC	G、J、K	1300	35MHz/0.5V	35	150	1.90	300	280
KTW1210HC1R5□GC	G、J、K	1500	7.9MHz/0.5V	30	50	1.95	310	160
KTW1210HC1R8□GC	G、J、K	1800	7.9MHz/0.5V	30	50	2.25	310	160
KTW1210HC2R2□GC	G、J、K	2200	7.9MHz/0.5V	30	50	2.41	310	110
KTW1210HC2R6□GC	G、J、K	2600	7.9MHz/0.5V	25	25	2.50	300	100
KTW1210HC2R7□GC	G、J、K	2700	7.9MHz/0.5V	25	25	2.85	300	100
KTW1210HC3R3□GC	G、J、K	3300	7.9MHz/0.5V	20	25	3.12	300	85
KTW1210HC3R5□GC	G、J、K	3500	7.9MHz/0.5V	20	25	3.20	300	82
KTW1210HC3R9□GC	G、J、K	3900	7.9MHz/0.5V	20	25	3.60	290	80
KTW1210HC4R7□GC	J、K	4700	7.9MHz/0.5V	16	25	4.00	280	60
KTW1210HC5R6□GC	J、K	5600	7.9MHz/0.5V	20	7.9	5.00	250	60
KTW1210HC6R8□GC	J、K	6800	7.9MHz/0.5V	20	7.9	8.00	230	55
KTW1210HC7R5□GC	J、K	7500	7.9MHz/0.5V	20	7.9	8.50	200	50
KTW1210HC8R2□GC	J、K	8200	7.9MHz/0.5V	20	7.9	8.60	170	50
KTW1210HC8R6□GC	J、K	8600	7.9MHz/0.5V	20	7.9	9.00	160	40
KTW1210HC100□GC	J、K	10000	7.9MHz/0.5V	22	7.9	6.80	200	20

① Inductance tested using an Agilent/HP4286A or equivalent.

② DCR measured on a micro-ohmmeter.

③ Rated current: The DC current at which the temperature rise $\Delta t=40^{\circ}\text{C}$ ($T_a=20^{\circ}\text{C}$).

④ □ Represents the tolerance of inductance: G ($\pm 2\%$); J ($\pm 5\%$); K ($\pm 10\%$).

4. Packaging Quantity: 2000 pcs per Reel.