

1. Dimensions

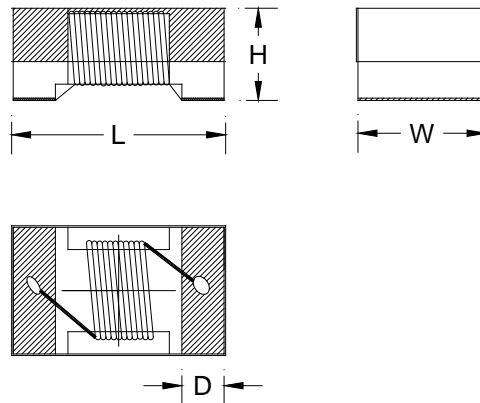

L	W	H	D
2.92 max.	2.79 max.	2.10 max.	0.50 typ.

2. Recommended Land Pattern

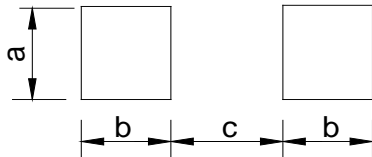

Symbol	Dimensions(mm)
a	2.54
b	1.02
c	1.27

2. Product Identification

KTW 1008 UC 1N0 □ S C

- ① Wire Wound Inductor Series;
- ② Dimensions: 1008(inch)=2520(mm)=2.5x2.0mm
- ③ Material: UC Ceramic core;
- ④ Inductance: 1N0=1.0nH、010=10nH、R10=100nH、1R0=1.0μH、100=10μH、101=100μH、102=1mH;
- ⑤ Tolerance: G---±2%; J---±5%; K---±10%;
- ⑥ Terminal: G--- Gold; S--- Tin;
- ⑦ Packaging type: C--- Tape& Reel.

3. Electrical Characteristics

Part Number	Accuracy grade	Inductance① (nH)	Inductance Test Conditions	Q value (MHz)min.	Q value Test frequency (MHz)	DCR ② (Ω)max.	Rated current ③ (mA)	SRF(MHz) min.
KTW1008UC3N9□GC	J、K	3.9	50MHz/0.5V	50	1500	0.035	1000	6000
KTW1008UC4N3□GC	J、K	4.3	50MHz/0.5V	50	1500	0.040	1000	6000
KTW1008UC4N7□GC	J、K	4.7	50MHz/0.5V	50	1500	0.045	1000	6000
KTW1008UC5N6□GC	J、K	5.6	50MHz/0.5V	30	1000	0.18	1000	6000
KTW1008UC010□GC	G、J、K	10	50MHz/0.5V	50	500	0.08	1000	4100
KTW1008UC012□GC	G、J、K	12	50MHz/0.5V	50	500	0.09	1000	3300
KTW1008UC015□GC	G、J、K	15	50MHz/0.5V	45	500	0.15	1000	2500
KTW1008UC018□GC	G、J、K	18	50MHz/0.5V	50	350	0.11	1000	2500
KTW1008UC020□GC	G、J、K	20	50MHz/0.5V	50	350	0.12	1000	2400
KTW1008UC022□GC	G、J、K	22	50MHz/0.5V	55	350	0.12	1000	2400
KTW1008UC024□GC	G、J、K	24	50MHz/0.5V	55	350	0.12	1000	2400
KTW1008UC027□GC	G、J、K	27	50MHz/0.5V	55	350	0.13	1000	1600
KTW1008UC033□GC	G、J、K	33	50MHz/0.5V	60	350	0.14	1000	1600
KTW1008UC036□GC	G、J、K	36	50MHz/0.5V	60	350	0.14	1000	1550
KTW1008UC039□GC	G、J、K	39	50MHz/0.5V	60	350	0.15	1000	1500
KTW1008UC047□GC	G、J、K	47	50MHz/0.5V	65	350	0.16	1000	1500
KTW1008UC051□GC	G、J、K	51	50MHz/0.5V	65	350	0.17	1000	1100
KTW1008UC056□GC	G、J、K	56	50MHz/0.5V	65	350	0.18	1000	1100
KTW1008UC068□GC	G、J、K	68	50MHz/0.5V	65	350	0.20	1000	1000
KTW1008UC075□GC	G、J、K	75	50MHz/0.5V	60	350	0.20	1000	1000
KTW1008UC082□GC	G、J、K	82	50MHz/0.5V	60	350	0.22	1000	1000
KTW1008UC090□GC	G、J、K	90	50MHz/0.5V	60	350	0.30	1000	1000
KTW1008UC091□GC	G、J、K	91	50MHz/0.5V	60	350	0.30	1000	1000
KTW1008UCR10□GC	G、J、K	100	25MHz/0.5V	60	350	0.56	650	1000
KTW1008UCR11□GC	G、J、K	110	25MHz/0.5V	60	350	0.60	650	950
KTW1008UCR12□GC	G、J、K	120	25MHz/0.5V	60	350	0.63	650	950
KTW1008UCR14□GC	G、J、K	140	25MHz/0.5V	45	100	0.68	600	900
KTW1008UCR15□GC	G、J、K	150	25MHz/0.5V	45	100	0.70	580	800

All specifications are subject to change without notice.

KTW1008UC Series

Wire Wound Chip Inductors

Part Number	Accuracy grade	Inductance ^① (nH)	Inductance Test Conditions	Q value (MHz)min.	Q value Test frequency (MHz)	DCR ^② (Ω)max.	Rated current ^③ (mA)	SRF(MHz) min.
KTW1008UCR16□GC	G、J、K	160	25MHz/0.5V	45	100	0.75	580	800
KTW1008UCR18□GC	G、J、K	180	25MHz/0.5V	45	100	0.77	620	640
KTW1008UCR20□GC	G、J、K	200	25MHz/0.5V	45	100	0.80	550	620
KTW1008UCR22□GC	G、J、K	220	25MHz/0.5V	45	100	0.84	500	620
KTW1008UCR24□GC	G、J、K	240	25MHz/0.5V	45	100	0.88	500	600
KTW1008UCR27□GC	G、J、K	270	25MHz/0.5V	45	100	0.91	500	600
KTW1008UCR30□GC	G、J、K	300	25MHz/0.5V	45	100	1.00	500	520
KTW1008UCR33□GC	G、J、K	330	25MHz/0.5V	45	100	1.05	450	500
KTW1008UCR36□GC	G、J、K	360	25MHz/0.5V	45	100	1.10	470	480
KTW1008UCR39□GC	G、J、K	390	25MHz/0.5V	45	100	1.12	470	480
KTW1008UCR43□GC	G、J、K	430	25MHz/0.5V	45	100	1.12	400	420
KTW1008UCR47□GC	G、J、K	470	25MHz/0.5V	45	100	1.19	470	450
KTW1008UCR50□GC	G、J、K	500	25MHz/0.5V	45	100	1.25	400	450
KTW1008UCR51□GC	G、J、K	510	25MHz/0.5V	45	100	1.30	400	430
KTW1008UCR56□GC	G、J、K	560	25MHz/0.5V	45	100	1.33	400	415
KTW1008UCR62□GC	G、J、K	620	25MHz/0.5V	45	100	1.40	400	375
KTW1008UCR66□GC	G、J、K	660	25MHz/0.5V	45	100	1.47	400	375
KTW1008UCR68□GC	G、J、K	680	25MHz/0.5V	45	100	1.47	400	375
KTW1008UCR75□GC	G、J、K	750	25MHz/0.5V	45	100	1.54	360	360
KTW1008UCR82□GC	G、J、K	820	25MHz/0.5V	45	100	1.61	400	250
KTW1008UCR91□GC	G、J、K	910	25MHz/0.5V	35	50	1.68	380	220
KTW1008UC1R0□GC	G、J、K	1000	25MHz/0.5V	35	50	1.75	370	210
KTW1008UC1R2□GC	G、J、K	1200	7.9MHz/0.5V	35	50	2.00	310	200
KTW1008UC1R5□GC	G、J、K	1500	7.9MHz/0.5V	28	50	2.30	330	180
KTW1008UC1R8□GC	G、J、K	1800	7.9MHz/0.5V	28	50	2.60	300	160
KTW1008UC2R0□GC	G、J、K	2000	7.9MHz/0.5V	20	50	2.80	280	90
KTW1008UC2R2□GC	G、J、K	2200	7.9MHz/0.5V	20	50	2.80	280	90
KTW1008UC2R7□GC	G、J、K	2700	7.9MHz/0.5V	22	25	3.20	290	80
KTW1008UC3R0□GC	G、J、K	3000	7.9MHz/0.5V	22	25	3.30	290	80
KTW1008UC3R3□GC	G、J、K	3300	7.9MHz/0.5V	22	25	3.40	290	70

All specifications are subject to change without notice.

KTW1008UC Series

Wire Wound Chip Inductors

Part Number	Accuracy grade	Inductance ^① (nH)	Inductance Test Conditions	Q value (MHz)min.	Q value Test frequency (MHz)	DCR ^② (Ω)max.	Rated current ^③ (mA)	SRF(MHz) min.
KTW1008UC3R9□GC	G、J、K	3900	7.9MHz/0.5V	16	25	3.60	260	60
KTW1008UC4R3□GC	G、J、K	4300	7.9MHz/0.5V	18	25	3.80	260	60
KTW1008UC4R7□GC	J、K	4700	7.9MHz/0.5V	18	25	4.00	260	60
KTW1008UC5R6□GC	J、K	5600	7.9MHz/0.5V	18	7.9	7.60	240	55
KTW1008UC6R8□GC	J、K	6800	7.9MHz/0.5V	18	7.9	8.20	200	50
KTW1008UC7R5□GC	J、K	7500	7.9MHz/0.5V	18	7.9	8.00	180	45
KTW1008UC8R2□GC	J、K	8200	7.9MHz/0.5V	18	7.9	8.20	170	40
KTW1008UC100□GC	J、K	10000	7.9MHz/0.5V	20	7.9	9.10	160	40

- ① Inductance tested using an Agilent/HP4286A or equivalent.
- ② DCR measured on a micro-ohmmeter.
- ③ Rated current: The DC current at which the temperature rise $\Delta t=40^{\circ}\text{C}$ ($T_a=20^{\circ}\text{C}$).
- ④ □ Represents the tolerance of inductance: G ($\pm 2\%$); J ($\pm 5\%$); K ($\pm 10\%$).

4. Packaging Quantity: 2000 pcs per Reel.