

1. Dimensions

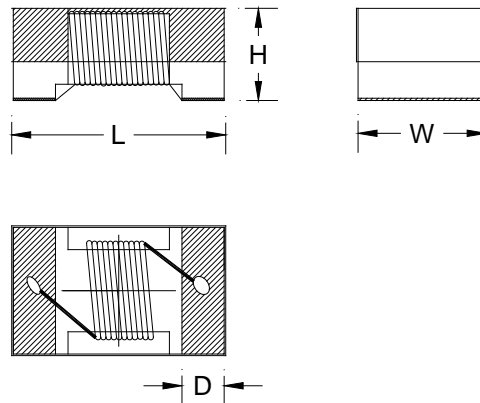

L	W	H	D
2.92 max.	2.79 max.	2.10 max.	0.50 typ.

2. Recommended Land Pattern

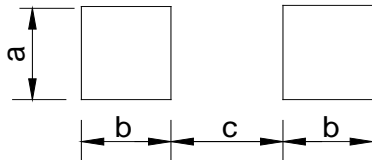

Symbol	Dimensions(mm)
a	2.54
b	1.02
c	1.27

2. Product Identification

KTW 1008 IF 1N0 □ S C
 ① ② ③ ④ ⑤ ⑥ ⑦

- ① Wire Wound Inductor Series;
- ② Dimensions: 1008(inch)=2520(mm)=2.5x2.0mm
- ③ Material: IF Ferrite core;
- ④ Inductance: 1N0=1.0nH、010=10nH、R10=100nH、1R0=1.0μH、100=10μH、101=100μH、102=1mH;
- ⑤ Tolerance: G---±2%; J---±5%; K---±10%;
- ⑥ Terminal: G--- Gold; S--- Tin;
- ⑦ Packaging type: C--- Tape& Reel.

3. Electrical Characteristics

Part Number	Accuracy grade	Inductance① (uH)	Inductance Test Conditions	Q value min.	Q value Test frequency (MHz)	DCR ② (Ω)max.	Rated current ③ (mA)	SRF(MHz) min.
KTW1008IFR12□GC	J、K	0.12	25.2MHz/0.5V	12	25.2	0.15	800	850
KTW1008IFR39□GC	J、K	0.39	25.2MHz/0.5V	12	25.2	0.29	600	480
KTW1008IFR56□GC	J、K	0.56	25.2MHz/0.5V	12	25.2	0.42	600	330
KTW1008IFR68□GC	J、K	0.68	25.2MHz/0.5V	12	25.2	0.45	600	330
KTW1008IFR82□GC	J、K	0.82	25.2MHz/0.5V	12	25.2	0.62	600	300
KTW1008IF1R0□GC	J、K	1.0	25.2MHz/0.5V	12	25.2	0.55	580	300
KTW1008IF1R2□GC	J、K	1.2	7.96MHz/0.5V	12	7.96	0.75	550	250
KTW1008IF1R5□GC	J、K	1.5	7.96MHz/0.5V	12	7.96	0.85	400	230
KTW1008IF1R8□GC	J、K	1.8	7.96MHz/0.5V	12	7.96	0.95	320	168
KTW1008IF2R2□GC	J、K	2.2	7.96MHz/0.5V	12	7.96	1.30	315	150
KTW1008IF2R7□GC	J、K	2.7	7.96MHz/0.5V	12	7.96	1.40	300	100
KTW1008IF3R3□GC	J、K	3.3	7.96MHz/0.5V	12	7.96	1.50	280	80
KTW1008IF3R9□GC	J、K	3.9	7.96MHz/0.5V	12	7.96	1.55	250	60
KTW1008IF4R7□GC	J、K	4.7	7.96MHz/0.5V	12	7.96	1.75	210	50
KTW1008IF5R1□GC	J、K	5.1	7.96MHz/0.5V	12	7.96	1.80	200	45
KTW1008IF5R6□GC	J、K	5.6	7.96MHz/0.5V	12	7.96	1.90	190	40
KTW1008IF6R8□GC	J、K	6.8	7.96MHz/0.5V	12	7.96	2.00	175	35
KTW1008IF7R5□GC	J、K	7.5	7.96MHz/0.5V	12	7.96	2.10	170	30
KTW1008IF8R2□GC	J、K	8.2	7.96MHz/0.5V	12	7.96	2.20	160	25
KTW1008IF100□GC	J、K	10	2.52MHz/0.5V	10	2.52	2.50	155	25
KTW1008IF120□GC	J、K	12	2.52MHz/0.5V	10	2.52	2.60	145	20
KTW1008IF150□GC	J、K	15	2.52MHz/0.5V	10	2.52	3.00	130	20
KTW1008IF180□GC	J、K	18	2.52MHz/0.5V	10	2.52	3.00	130	20
KTW1008IF220□GC	J、K	22	2.52MHz/0.5V	10	2.52	3.90	105	18
KTW1008IF270□GC	J、K	27	2.52MHz/0.5V	10	2.52	4.00	100	10
KTW1008IF330□GC	J、K	33	2.52MHz/0.5V	10	2.52	4.80	85	8
KTW1008IF390□GC	J、K	39	2.52MHz/0.5V	10	2.52	5.00	80	7
KTW1008IF470□GC	J、K	47	2.52MHz/0.5V	10	2.52	5.70	60	7

All specifications are subject to change without notice.

KTW1008IF Series

Wire Wound Chip Inductors

Part Number	Accuracy grade	Inductance ^① (uH)	Inductance Test Conditions	Q value min.	Q value Test frequency (MHz)	DCR ^② (Ω)max.	Rated current ^③ (mA)	SRF(MHz) min.
KTW1008IF560□GC	J、K	56	2.52MHz/0.5V	10	2.52	6.00	55	6.5
KTW1008IF680□GC	J、K	68	2.52MHz/0.5V	10	2.52	6.70	50	6.5
KTW1008IF820□GC	J、K	82	2.52MHz/0.5V	10	2.52	7.50	45	6.5
KTW1008IF101□GC	J、K	100	0.796MHz/0.5V	8	0.796	11.0	40	4.5
KTW1008IF121□GC	J、K	120	0.796MHz/0.5V	8	0.796	13.0	30	3
KTW1008IF151□GC	J、K	150	0.796MHz/0.5V	8	0.796	15.0	25	3
KTW1008IF221□GC	K	220	0.796MHz/0.5V	8	0.796	18.0	20	2.5

- ① Inductance tested using an Agilent/HP4286A or equivalent.
- ② DCR measured on a micro-ohmmeter.
- ③ Rated current: The DC current at which the temperature rise $\Delta t=40^{\circ}\text{C}$ ($T_a=20^{\circ}\text{C}$).
- ④ □ Represents the tolerance of inductance: G ($\pm 2\%$); J ($\pm 5\%$); K ($\pm 10\%$).

4. Packaging Quantity: 2000 pcs per Reel.