

1. Dimensions

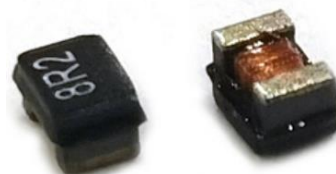

L	W	H	D
1.8 max.	1.25 max.	1.2 max.	0.30 typ.

2. Recommended Land Pattern

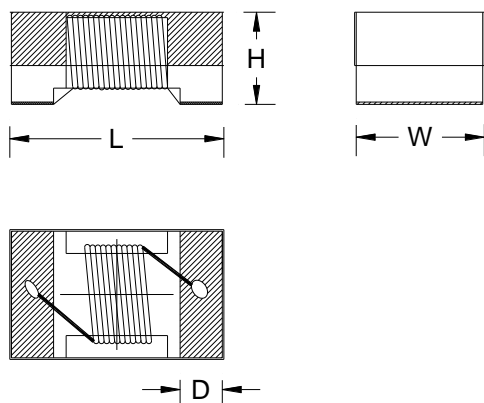
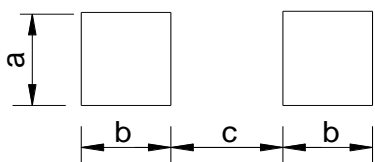

Symbol	Dimensions(mm)
a	1.02
b	0.64
c	0.64

2. Product Identification

KTW 0603 UF 1N0 □ S C
 ① ② ③ ④ ⑤ ⑥ ⑦

- ① Wire Wound Inductor Series;
- ② Dimensions: 0603(inch)=1608(mm)=1.6x0.8mm
- ③ Material: UF Ferrite core;
- ④ Inductance: 1N0=1.0nH、010=10nH、R10=100nH、1R0=1.0μH、100=10μH、101=100μH、102=1mH;
- ⑤ Tolerance: J ±5%; K ±10%;
- ⑥ Terminal: S-Tin;
- ⑦ Packaging type: C--- Tape& Reel.

3. Electrical Characteristics

Part Number	Accuracy grade	Inductance① (uH)	Inductance Test Conditions	Q value min.	Q value Test frequency (MHz)	DCR ② (Ω)max.	Rated current ③ (mA)	SRF(MHz) min.
KTW0603UF047□SC	J、K	0.047	7.9MHz/0.5V	12	7.9	0.10	1000	1500
KTW0603UF072□SC	J、K	0.072	7.9MHz/0.5V	12	7.9	0.12	1000	1400
KTW0603UF082□SC	J、K	0.082	7.9MHz/0.5V	12	7.9	0.10	1000	1300
KTW0603UFR10□SC	J、K	0.10	7.9MHz/0.5V	12	7.9	0.13	1000	1150
KTW0603UFR12□SC	J、K	0.12	7.9MHz/0.5V	12	7.9	0.16	1000	1100
KTW0603UFR15□SC	J、K	0.15	7.9MHz/0.5V	12	7.9	0.15	1000	1050
KTW0603UFR18□SC	J、K	0.18	7.9MHz/0.5V	12	7.9	0.18	1000	950
KTW0603UFR22□SC	J、K	0.22	7.9MHz/0.5V	12	7.9	0.20	900	900
KTW0603UFR24□SC	J、K	0.24	7.9MHz/0.5V	12	7.9	0.28	850	800
KTW0603UFR27□SC	J、K	0.27	7.9MHz/0.5V	12	7.9	0.30	700	775
KTW0603UFR33□SC	J、K	0.33	7.9MHz/0.5V	12	7.9	0.32	600	725
KTW0603UFR39□SC	J、K	0.39	7.9MHz/0.5V	12	7.9	0.51	500	620
KTW0603UFR47□SC	J、K	0.47	7.9MHz/0.5V	12	7.9	0.62	420	540
KTW0603UFR56□SC	J、K	0.56	7.9MHz/0.5V	12	7.9	0.65	400	600
KTW0603UFR68□SC	J、K	0.68	7.9MHz/0.5V	12	7.9	1.00	380	500
KTW0603UFR78□SC	J、K	0.78	7.9MHz/0.5V	12	7.9	1.30	370	450
KTW0603UFR82□SC	J、K	0.82	7.9MHz/0.5V	12	7.9	1.30	350	500
KTW0603UF1R0□SC	J、K	1.0	7.9MHz/0.5V	12	7.9	1.50	330	400
KTW0603UF1R2□SC	J、K	1.2	7.9MHz/0.5V	12	7.9	1.70	320	380
KTW0603UF1R5□SC	J、K	1.5	7.9MHz/0.5V	12	7.9	1.90	310	300
KTW0603UF1R8□SC	J、K	1.8	7.9MHz/0.5V	12	7.9	2.20	300	180
KTW0603UF2R2□SC	J、K	2.2	7.9MHz/0.5V	12	7.9	2.30	280	180
KTW0603UF2R7□SC	J、K	2.7	7.9MHz/0.5V	12	7.9	3.10	250	150
KTW0603UF3R3□SC	J、K	3.3	7.9MHz/0.5V	12	7.9	2.90	230	150
KTW0603UF3R9□SC	J、K	3.9	7.9MHz/0.5V	12	7.9	3.20	210	120
KTW0603UF4R7□SC	J、K	4.7	7.9MHz/0.5V	12	7.9	4.0	200	100
KTW0603UF5R6□SC	J、K	5.6	7.9MHz/0.5V	12	7.9	2.6	240	32
KTW0603UF6R8□SC	J、K	6.8	7.9MHz/0.5V	12	7.9	3.9	200	31
KTW0603UF8R2□SC	J、K	8.2	7.9MHz/0.5V	12	7.9	4.2	190	26
KTW0603UF100□SC	J、K	10	2.5MHz/0.5V	10	2.5	4.8	180	25
KTW0603UF150□SC	J、K	15	2.5MHz/0.5V	10	2.5	8.5	170	23
KTW0603UF180□SC	J、K	18	2.5MHz/0.5V	10	2.5	10	160	22
KTW0603UF220□SC	J、K	22	2.5MHz/0.5V	10	2.5	12	100	10

① Inductance tested using an Agilent/HP4286A or equivalent.

② DCR measured on a micro-ohmmeter.

③ Rated current: The DC current at which the temperature rise $\Delta t=40^{\circ}\text{C}$ ($T_a=20^{\circ}\text{C}$).

④ □ Represents the tolerance of inductance: G ($\pm 2\%$); J ($\pm 5\%$); K ($\pm 10\%$).

4. Packaging Quantity: 4000 pcs per Reel.

All specifications are subject to change without notice.