

1. Dimensions

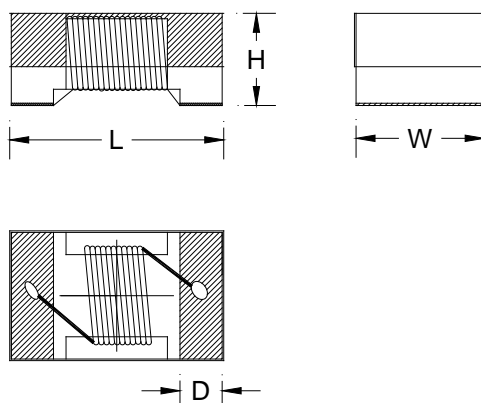

L	W	H	D
1.78 max.	1.10 max.	0.95 max.	0.30 typ.

2. Recommended Land Pattern

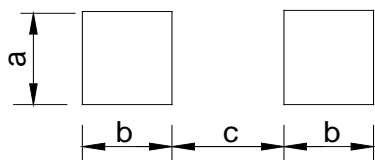

Symbol	Dimensions(mm)
a	1.02
b	0.64
c	0.64

2. Product Identification

KTW 0603 UC 1N0 □ S C

- ① Wire Wound Inductor Series;
- ② Dimensions: 0603(inch)=1608(mm)=1.6x0.8mm
- ③ Material: UC Ceramic core;
- ④ Inductance: 1N0=1.0nH、010=10nH、R10=100nH、1R0=1.0μH、100=10μH、101=100μH、102=1mH;
- ⑤ Tolerance: G---±2%; J---±5%; K---±10%;
- ⑥ Terminal: G--- Gold; S--- Tin;
- ⑦ Packaging type: C--- Tape& Reel.

3. Electrical Characteristics

Part Number	Accuracy grade	Inductance① (nH)	Inductance Test Conditions	Q value min.	Q value Test frequency (MHz)	DCR ② (Ω)max.	Rated current ③ (mA)	SRF(MHz) min.
KTW0603UC1N6□SC	K	1.6	250MHz/0.5V	18	250	0.04	700	12500
KTW0603UC1N7□SC	J、K	1.7	250MHz/0.5V	18	250	0.045	700	12500
KTW0603UC1N8□SC	K	1.8	250MHz/0.5V	16	250	0.045	700	12500
KTW0603UC2N0□SC	J、K	2.0	250MHz/0.5V	12	250	0.09	700	10000
KTW0603UC2N2□SC	K	2.2	250MHz/0.5V	12	250	0.09	700	10000
KTW0603UC3N3□SC	K	3.3	250MHz/0.5V	20	250	0.075	700	5900
KTW0603UC3N6□SC	G、J、K	3.6	250MHz/0.5V	22	250	0.075	700	5900
KTW0603UC3N9□SC	G、J、K	3.9	250MHz/0.5V	22	250	0.08	700	6900
KTW0603UC4N3□SC	G、J、K	4.3	250MHz/0.5V	22	250	0.075	700	5900
KTW0603UC4N7□SC	G、J、K	4.7	250MHz/0.5V	20	250	0.116	700	5800
KTW0603UC5N1□SC	G、J、K	5.1	250MHz/0.5V	20	250	0.120	700	5700
KTW0603UC5N6□SC	K	5.6	250MHz/0.5V	18	250	0.20	700	5700
KTW0603UC6N0□SC	G、J、K	6.0	250MHz/0.5V	27	250	0.11	700	5700
KTW0603UC6N2□SC	G、J、K	6.2	250MHz/0.5V	27	250	0.11	700	5700
KTW0603UC6N8□SC	G、J、K	6.8	250MHz/0.5V	27	250	0.11	700	5800
KTW0603UC7N5□SC	G、J、K	7.5	250MHz/0.5V	28	250	0.11	700	4800
KTW0603UC8N2□SC	G、J、K	8.2	250MHz/0.5V	28	250	0.12	700	4700
KTW0603UC8N7□SC	G、J、K	8.7	250MHz/0.5V	28	250	0.12	700	4600
KTW0603UC9N1□SC	G、J、K	9.1	250MHz/0.5V	26	250	0.15	700	4500
KTW0603UC9N5□SC	G、J、K	9.5	250MHz/0.5V	26	250	0.15	700	5400
KTW0603UC010□SC	G、J、K	10	250MHz/0.5V	31	250	0.13	700	4800
KTW0603UC011□SC	G、J、K	11	250MHz/0.5V	33	250	0.13	700	4000
KTW0603UC012□SC	G、J、K	12	250MHz/0.5V	35	250	0.13	700	4000
KTW0603UC013□SC	G、J、K	13	250MHz/0.5V	30	250	0.14	700	4000
KTW0603UC014□SC	G、J、K	14	250MHz/0.5V	35	250	0.14	700	4000
KTW0603UC015□SC	G、J、K	15	250MHz/0.5V	30	250	0.15	700	4000
KTW0603UC016□SC	G、J、K	16	250MHz/0.5V	34	250	0.16	700	3300
KTW0603UC018□SC	G、J、K	18	250MHz/0.5V	35	250	0.17	700	3100

All specifications are subject to change without notice.

KTW0603UC Series

Wire Wound Chip Inductors



Part Number	Accuracy grade	Inductance ^① (nH)	Inductance Test Conditions	Q value min.	Q value Test frequency (MHz)	DCR ^② (Ω)max.	Rated current ^③ (mA)	SRF(MHz) min.
KTW0603UC020□SC	G、J、K	20	250MHz/0.5V	38	250	0.19	700	3000
KTW0603UC022□SC	G、J、K	22	250MHz/0.5V	38	250	0.19	700	3000
KTW0603UC024□SC	G、J、K	24	250MHz/0.5V	37	250	0.20	700	2650
KTW0603UC025□SC	G、J、K	25	250MHz/0.5V	38	250	0.21	700	2600
KTW0603UC027□SC	G、J、K	27	250MHz/0.5V	36	250	0.22	600	2800
KTW0603UC030□SC	G、J、K	30	250MHz/0.5V	37	250	0.22	600	2250
KTW0603UC033□SC	G、J、K	33	250MHz/0.5V	36	250	0.22	600	2300
KTW0603UC036□SC	G、J、K	36	250MHz/0.5V	36	250	0.25	600	2080
KTW0603UC039□SC	G、J、K	39	250MHz/0.5V	40	250	0.25	600	2200
KTW0603UC043□SC	G、J、K	43	250MHz/0.5V	36	250	0.28	600	2000
KTW0603UC047□SC	G、J、K	47	200MHz/0.5V	36	200	0.28	600	2000
KTW0603UC049□SC	G、J、K	49	200MHz/0.5V	36	200	0.28	600	2000
KTW0603UC051□SC	G、J、K	51	200MHz/0.5V	36	200	0	600	1900
KTW0603UC056□SC	G、J、K	56	200MHz/0.5V	38	200	0.28	600	1900
KTW0603UC068□SC	G、J、K	68	200MHz/0.5V	36	200	0.34	600	1700
KTW0603UC072□SC	G、J、K	72	150MHz/0.5V	34	150	0.53	400	1700
KTW0603UC075□SC	G、J、K	75	150MHz/0.5V	30	150	0.60	400	1400
KTW0603UC082□SC	G、J、K	82	150MHz/0.5V	34	150	0.55	400	1700
KTW0603UC091□SC	G、J、K	91	150MHz/0.5V	30	150	0.63	400	1400
KTW0603UCR10□SC	G、J、K	100	150MHz/0.5V	30	150	0.63	400	1400
KTW0603UCR11□SC	G、J、K	110	150MHz/0.5V	32	150	0.67	300	1350
KTW0603UCR12□SC	G、J、K	120	150MHz/0.5V	32	150	0.73	300	1300
KTW0603UCR15□SC	G、J、K	150	150MHz/0.5V	28	150	0.80	280	990
KTW0603UCR16□SC	J、K	160	100MHz/0.5V	25	100	1.25	250	990
KTW0603UCR18□SC	G、J、K	180	100MHz/0.5V	25	100	1.45	240	990
KTW0603UCR20□SC	G、J、K	200	100MHz/0.5V	25	100	1.55	200	900
KTW0603UCR22□SC	G、J、K	220	100MHz/0.5V	25	100	2.10	200	900
KTW0603UCR25□SC	G、J、K	250	100MHz/0.5V	25	100	3.55	120	822
KTW0603UCR27□SC	G、J、K	270	100MHz/0.5V	24	100	2.30	170	900
KTW0603UCR30□SC	G、J、K	300	100MHz/0.5V	24	100	3.00	100	1000

All specifications are subject to change without notice.

KTW0603UC Series

Wire Wound Chip Inductors

Part Number	Accuracy grade	Inductance ^① (nH)	Inductance Test Conditions	Q value min.	Q value Test frequency (MHz)	DCR ^② (Ω)max.	Rated current ^③ (mA)	SRF(MHz) min.
KTW0603UCR33□SC	G、J、K	330	100MHz/0.5V	25	100	3.89	100	900
KTW0603UCR39□SC	G、J、K	390	100MHz/0.5V	25	100	4.35	100	800
KTW0603UCR47□SC	G、J、K	470	100MHz/0.5V	25	100	7.00	75	700

- ① Inductance tested using an Agilent/HP 4286A or equivalent.
- ② DCR measured on a micro-ohmmeter.
- ③ Rated current: The DC current at which the temperature rise $\Delta t=40^{\circ}\text{C}$ ($T_a=20^{\circ}\text{C}$).
- ④ □ Represents the accuracy level of inductance: G ($\pm 2\%$); J ($\pm 5\%$); K ($\pm 10\%$).

4. Packaging Quantity: 4000 pcs per Reel.